

## Connectors | 13-pin

12 V | ISO 11446 | 40 mm

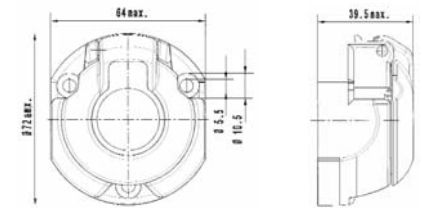

Art.-No.	Description
	<b>13-pin socket ISO 11446</b> <b>40 mm</b> <ul style="list-style-type: none"> <li>Impact resistant plastic</li> <li>Load capacity: 20 A at 12 V</li> <li>Seal of santoprene in the cover</li> <li>Material: Plastic PA6 MD30</li> <li>Incl. grommet</li> <li>Available with crimping tools</li> </ul>
	<b>with crimp contacts (stamped contacts)</b> 780 500 200 Without microswitch for rear fog light, axial exit 780 700 200 Without microswitch for rear fog light, right exit 780 510 200 With microswitch for rear fog light, axial exit 780 710 200 With microswitch for rear fog light, right exit
	<b>with soldering contacts (massive contacts)</b> 780 500 100 Without microswitch for rear fog light, axial exit 780 700 100 Without microswitch for rear fog light, right exit 780 510 100 With microswitch for rear fog light, axial exit 780 710 100 With microswitch for rear fog light, right exit
... .. 1	<b>Individual packaging</b>
	<b>Accessories</b> <b>Crimp contacts for socket ISO 11446</b> <b>RAM-Contact sleeve</b> 780 301 930 0,5 – 1,0 mm <sup>2</sup> (Reel of 3.000 pcs) 780 301 920 1,0 – 2,5 mm <sup>2</sup> (Reel of 3.000 pcs) 780 301 940 2,5 – 6,0 mm <sup>2</sup> (Reel of 3.000 pcs)
	<b>Soldering contacts (also crimpable) for socket ISO 11446</b> 780 910 100 0,5 mm <sup>2</sup> 780 910 200 1,0 mm <sup>2</sup> 780 910 300 1,5 mm <sup>2</sup> 780 910 400 2,5 mm <sup>2</sup>



Grommet

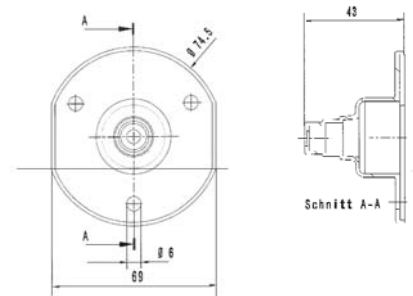

Crimp contacts

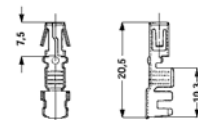

Soldering

